

DSD-12SSN30 DC SPUR GEAR MOTOR

典型应用/Typical applications :

自动快锁门、装订机、自动电视架、点钞机、聚光灯、卫生纸机、办公设备、家用电器、自动执行机构

Auto shutter, binding machine, automatic TV rack, money counter, spot light, tissue machine, office equipments, household appliances, automatic actuator

DRAWING (MM)

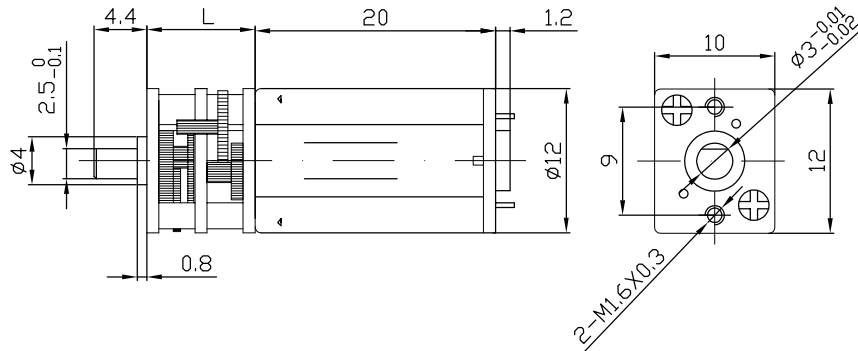

齿轮箱参数/ GEARBOX DATA:

| 级数 Reduction stage | 2 | 3 | 4 | 5 | 7 |
|--------------------------------|-----|----------|----------------|--------------------------|-------|
| 减速比 Reduction ratio | 10K | 20K, 30K | 50K, 63K, 100K | 150K, 210K 250K, 298K | 1000K |
| 齿轮箱长度 Gearbox length "L" mm | 9 | 9 | 9 | 9 | 12 |
| 齿轮箱效率 Gearbox efficiency | 81% | 73% | 66% | 59% | 48% |

电机参数/ MOTOR DATA:

| 电机型号 Motor model | 额定电压 Rated voltage | 空载/No load | | 负载/Load | | | | 堵转/Stall | |
|---------------------|-----------------------|------------|-------|---------|-------|--------|--------|----------|---------|
| | | 电流 | 转速 | 电流 | 转速 | 扭矩 | 功率 | 扭矩 | 电流 |
| | | Current | Speed | Current | Speed | Torque | Output | Torque | Current |
| DSD-N304.526300 | V | mA | rpm | mA | rpm | gf. cm | W | gf. cm | mA |
| | 4.5 | ≤130 | 26300 | ≤610 | 23200 | 5 | 1.2 | ≥37 | ≥2200 |

电机参数谨供参考, 请以实际样板为准。

The motor data are for reference only, real samples may be with different specifications.

齿轮箱电机输出扭矩: 电机输出扭矩 x 减速比 x 齿轮箱效率; 齿轮箱电机输出转速: 电机输出转速 / 减速比。

Output torque of gear motor : output torque of motor x reduction ratio x gearbox efficiency;

Output speed of gear motor: output speed of motor / reduction ratio.