



DSD-25RS370 DC SPUR GEAR MOTOR

典型应用/Typical applications :

自动快锁门、装订机、自动电视架、点钞机、聚光灯、卫生纸机、办公设备、家用电器、自动执行机构

Auto shutter, binding machine, automatic TV rack, money counter, spot light, tissue machine, office equipments, household appliances, automatic actuator

DRAWING (MM)

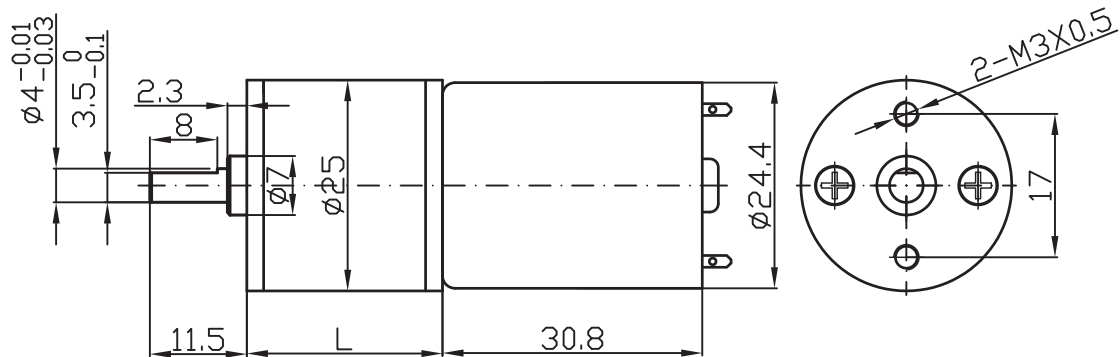

齿轮箱参数/GEARBOX DATA:

级数 Reduction stage	4	5	6	7	8
减速比 Reduction ratio	20.4K	35.8K, 45K 50K	78K, 99K, 110K 122K, 127K	217K, 241K, 268K 298K, 331K	478K, 531K, 590K 656K, 729K
齿轮箱长度 Gearbox length "L" mm	20.8	23.2	25.6	28	29
齿轮箱效率 Gearbox efficiency	65%	59%	53%	48%	43%

电机参数/MOTOR DATA:

电机型号 Motor model	额定电压 Rated voltage	空载/No load		负载/Load				堵转/Stall	
		电流	转速	电流	转速	扭矩	功率	扭矩	电流
		Current	Speed	Current	Speed	Torque	Output	Torque	Current
	V	mA	rpm	mA	rpm	gf. cm	W	gf. cm	mA
DSD-3700065000	6	≤45	5000	≤240	4200	20	0.88	≥112	≥1100
DSD-3700126000	12	≤42	6000	≤150	5000	20	1.05	≥108	≥980
DSD-37001212000	12	≤90	12000	≤520	10300	28	2.96	≥177	≥2500
DSD-3700246000	24	≤21	6000	≤110	5100	21	1.12	≥126	≥440
DSD-3700249000	24	≤43	9000	≤210	7800	27	2.20	≥182	≥950

电机参数仅供参考, 请以实际样板为准。

The motor data are for reference only, real samples may be with different specifications.

齿轮箱电机输出扭矩: 电机输出扭矩 x 减速比 x 齿轮箱效率; 齿轮箱电机输出转速: 电机输出转速 / 减速比。

Output torque of gear motor: output torque of motor x reduction ratio x gearbox efficiency;

Output speed of gear motor: output speed of motor / reduction ratio.