



DSD-51SW180 DC WORM GEAR MOTOR

典型应用/Typical applications :

自动快锁门、装订机、自动电视架、点钞机、聚光灯、卫生纸机、办公设备、家用电器、自动执行机构

Auto shutter, binding machine, automatic TV rack, money counter, spot light, tissue machine, office equipments, household appliances, automatic actuator

DRAWING (MM)

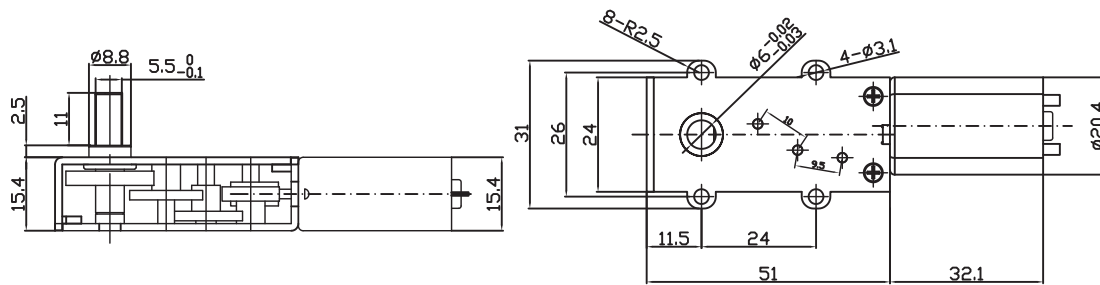

齿轮箱参数/GEARBOX DATA:

级数 Reduction stage	4
减速比 Reduction ratio	734K
齿轮箱长度 Gearbox length "L" mm	15.4
齿轮箱效率 Gearbox efficiency	65%

电机参数/MOTOR DATA:

电机型号 Motor model	额定电压 Rated voltage	空载/No load		负载/Load				堵转/Stall	
		电流	转速	电流	转速	扭矩	功率	扭矩	电流
		Current	Speed	Current	Speed	Torque	Output	Torque	Current
	V	mA	rpm	mA	rpm	gf. cm	W	gf. cm	mA
DSD-1800055000	5	≤75	5000	≤158	4000	19	0.80	≥85	≥790
DSD-1800128000	12	≤35	8000	≤300	6200	26	1.69	≥104	≥770
DSD-1800249000	24	≤36	9000	≤120	7600	15	1.17	≥86	≥470

电机参数仅供参考, 请以实际样板为准。

The motor data are for reference only, real samples may be with different specifications.

齿轮箱电机输出扭矩: 电机输出扭矩 x 减速比 x 齿轮箱效率; 齿轮箱电机输出转速: 电机输出转速 / 减速比。

Output torque of gear motor: output torque of motor x reduction ratio x gearbox efficiency;

Output speed of gear motor: output speed of motor / reduction ratio.